

MOSSLEY AREA GREEN SPACES: DRAFT BIODIVERSITY PLANS 27-30



Lesser Celandine, Blackshaw Close, Mossley

GREEN SPACES INCLUDED:

27 Derwent Drive-Canal
28 Isis Close-Tamar Close

29 Bridgewater Close-Telford Close
30 Blackshaw Close

Also see Introduction, Appendix 1 with survey plans and notes for each site, and Appendix 2 with examples and references.

DERWENT DRIVE GREEN SPACE

Site biodiversity plan 27



Derwent Drive green space, tilted aerial photo 2021 looking north

Biodiversity aims

Opportunities for biodiversity enrichment and interest for users developed in this canal-side green space through management of newly established and existing habitats.

Site information

Location	Between Derwent Drive and the Macclesfield Canal, off Canal Road, Congleton
Description	Amenity grassland, within a housing estate and close to the Macclesfield Canal, with recent hedge, orchard, tree and shrub and wildflower planting
Use	Used by local residents when ground is dry enough, and as a through route to the canal towpath
Total area	0.23 hectares (0.57 acres)
UK BAP priority habitats and species	Hedgerow, native black poplars.
Biodiversity evaluation 2022	Previously low. Trend - improving.

Potential for biodiversity enhancement



Note

Proposals are based on a quick habitat survey carried out in April 2022. Additional data from people who use the site, local naturalists and others would be welcomed. These initial proposals are for discussion and consultation so are liable to change.

ISIS CLOSE-TAMAR CLOSE CLOSE GREEN SPACES

Site biodiversity plan 28



Isis Close-Tamar Close, tilted aerial photo 2021

Biodiversity aims

Maximise the biodiversity benefit by creating a mosaic of habitats which provide stepping stones for wildlife, connecting to the railway ecological corridor, and private gardens where possible.

Site information

Location	Isis Close and Tamar Close lie to the south of Derwent Drive, Congleton (area off Canal Street, between the Macclesfield Canal and the railway line).
Description	Small areas of informal amenity green space linking cul-de-sacs within a housing estate.
Use	Varied. The area to the west of Isis Close has amenity value but limited space for recreational use. The area between Isis Close and Tamar Close provides a through route. East of Tamar Close the green space seems little used.
Total area	0.22 hectares combined (0.54 acres).
BAP Priority Habitats and Species	None known.
Biodiversity evaluation 2022	Low (relative to 30 Congleton green spaces surveyed). Trend - static or enhancing

Potential for biodiversity enhancement



Note

Proposals are based on a quick habitat survey carried out in April 2022. Additional data from people who use the site, local naturalists and others would be welcomed. These initial proposals are for discussion and consultation so are liable to change.

BRIDGEWATER CLOSE GREEN SPACE

Site biodiversity plan 29



Bridgewater Close green space, tilted aerial view 2021

Biodiversity aims

Increased diversity of habitats and species through woodland and grassland management and creation of small areas of wildflower meadow and wetland.

Site information

Location	To the west of Bridgewater Close, Telford Close and Worsley Drive, Mossley, Congleton.
Description	Large informal amenity open space to the north of the Macclesfield Canal which is enclosed and often shaded by wooded bunds.
Use	Low to moderate, constrained by poor surface water drainage and perhaps its relatively peripheral location within Mossley.
Total area	1.1 hectares (2.71 acres)
BAP priority habitats & species	None identified - the green space was created in the 1970/80s, at least partly on made up land with former farmland and small valley erased. Surveys may identify species of interest due to proximity to the canal corridor.
Biodiversity evaluation 2022	Moderate-good, with good green infrastructure links. Trend - improving. This is one of Congleton Town Council's rewilding sites.

Potential for biodiversity enhancement



Note

Proposals are based on a quick habitat survey carried out in April 2022. Additional data from people who use the site, local naturalists and others would be welcomed. These initial proposals are for discussion and consultation so are liable to change.

BLACKSHAW CLOSE GREEN SPACE

Site biodiversity plan 30



Blackshaw Close green space, tilted aerial view 2021

Biodiversity aims

Increase proportion of native woodland plants on this area of infilled clough, to improve integration with adjacent ancient woodland, and benefit wildlife.

Site information

Location	Blackshaw Close, Henshall Hall Estate, Mossley, Congleton.
Description	Wooded area of public open space
Total area	0.28 hectares (0.69 acres)
Use	Mainly used by local residents
BAP Priority Habitats and Species	None identified on site, but immediately next to priority lowland deciduous woodland habitat which is a Local Wildlife Site, one of many connected woodlands along the Dane Valley. This in turn is next to Dane in Shaw Pasture SSSI.
Biodiversity evaluation 2022	Moderate (relative to 30 green spaces surveyed). A restored landscape on an infilled clough. Trend - improving, as central area is naturalising.

Potential for biodiversity enhancement

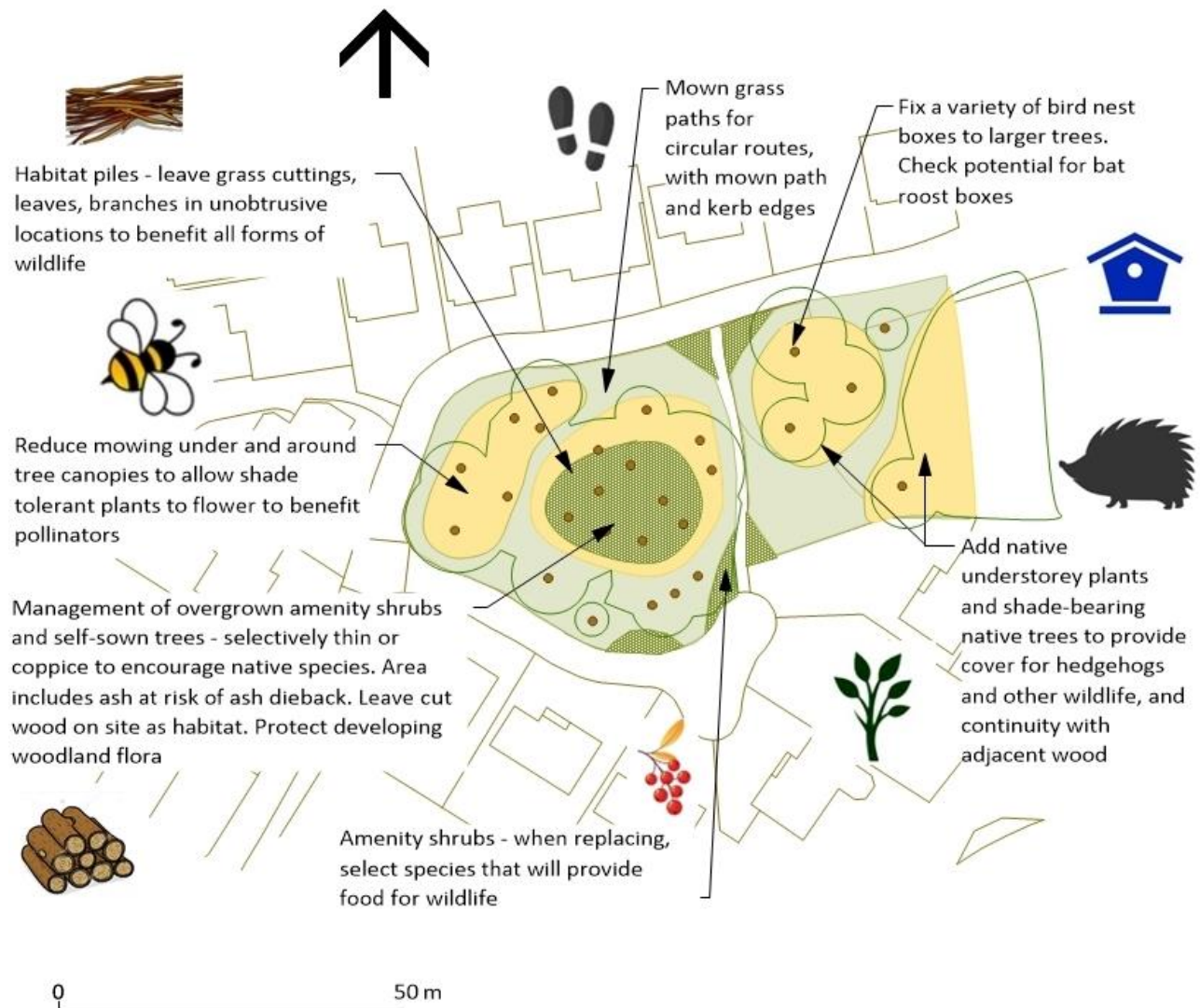

Note

Proposals are based on a quick habitat survey carried out in April 2022. Additional data from people who use the site, local naturalists and others would be welcomed. These initial proposals are for discussion and consultation so are liable to change.